

**LEGEND**

	EXISTING	FUTURE
BUILDINGS	[Solid Grey Box]	[Dotted Grey Box]
AIRFIELD PAVEMENT	[Solid Grey Box]	[Dotted Grey Box]
BUILDING RESTRICTION LINE (BRL)	BRL (E)	BRL (F)
AIRCRAFT PARKING LINE (APL)	APL (E)	APL (F)
AIRPORT PROPERTY LINE	[Solid Blue Line]	[Dashed Blue Line]
RUNWAY SAFETY AREA (RSA)	[Dashed Blue Line]	[Dashed Red Line]
OBJECT FREE AREA (OFA)	[Dashed Blue Line]	[Dashed Red Line]
OBSTACLE FREE ZONE (OFZ)	[Dashed Blue Line]	[Dashed Red Line]
TAXIWAY OBJECT FREE AREA (TOFA)	[Dashed Blue Line]	SAME
RUNWAY PROTECTION ZONE (RPZ)	[Dashed Blue Line]	[Dashed Red Line]
TERPS DEPARTURE SURFACE	[Dashed Blue Line]	SAME
OBSTACLE CLEARANCE SURFACE (OCS)	[Dashed Blue Line]	SAME
GROUND CONTOURS	10'	SAME
AIRPORT REFERENCE POINT (ARP)	[Symbol]	[Symbol]
RUNWAY END IDENTIFIER LIGHTS (REIL)	[Symbol]	SAME
VISUAL GUIDANCE INDICATORS (PAPI)	[Symbol]	SAME
WIND INDICATOR	[Symbol]	[Symbol]
SEGMENTED CIRCLE/WIND INDICATOR	[Symbol]	[Symbol]
FENCE	[Symbol]	[Symbol]
BEACON	[Symbol]	SAME
THRESHOLD LIGHTS	[Symbol]	SAME
ACCESS ROAD/VEHICLE PARKING	[Symbol]	[Symbol]
DEVELOPMENT RESERVE (PAVEMENT/BUILDINGS)	N/A	[Symbol]
TO BE REMOVED	[Symbol]	N/A
HIGH INTENSITY RUNWAY LIGHTS (HIRL)	[Symbol]	SAME
PRECISION OBSTACLE FREE ZONE (POFZ)	[Symbol]	SAME
AVIGATION EASEMENT	[Symbol]	[Symbol]

- NOTES:**
- ENTIRE AIRPORT PROPERTY LINE NOT DEPICTED ON THIS DRAWING DUE TO SCALE REQUIREMENTS. SEE SHEET 12 OF 14 FOR DEPICTION OF FULL AIRPORT BOUNDARY.
  - RESERVES (DEPICTED IN GREEN) ARE FOR REFERENCE ONLY TO GUIDE FUTURE PLANNING BEYOND CURRENT DEMAND FORECASTS.
  - THERE ARE NO OBSTACLE FREE ZONE (OFZ) PENETRATIONS FOR RUNWAY 2/20.
  - SOURCES FOR EXISTING COORDINATES AND ELEVATIONS: ASISDATA SHEET SYSTEM (ADS) BREMERTON NATIONAL AIRPORT DATUM NAD-83, NGVD 88, AND USGS MAPS USING NAD-27.
  - NDB TO BE REMOVED OR RELOCATED.
  - RUNWAY 2 EXTENSION RESERVE BASED ON ARC C/D-II STANDARDS.
  - EXISTING RACEWAY FACILITIES TO BE CLOSED/RELOCATED. PAVEMENT TO BE MARKED AS NON-AERONAUTICAL.
  - THE ROADWAY SECTIONS LOCATED INSIDE THE CONTROLLED AVIATION USE DEVELOPMENT EXCLUSIVELY AND ARE ELIGIBLE FOR FAA FUNDING. THE SECTIONS OF NEW ROADWAY CONSTRUCTED OUTSIDE THE CONTROLLED AVIATION USE DEVELOPMENT EXCLUSIVELY WILL NOT BE ELIGIBLE FOR FAA FUNDING SINCE THEY WILL PROVIDE ACCESS TO THE AIRPORT AND ADJACENT AREAS OFF AIRPORT PROPERTY.

**BUILDING/FACILITY KEY**

NO.	DESCRIPTION
1	PORT OWNED HANGAR (EXISTING)
2	TENANT OWNED HANGAR (EXISTING)
3	FIRE STATION
4	TERMINAL BUILDINGS/PORT OFFICES
5	FBO HANGAR (PORT OWNED)
6	AVGAS SELF FUELING AREA
7	AVGAS BULK FUEL STORAGE AREA (EXISTING)
8	AIRPORT MAINTENANCE BUILDING
9	JET FUEL BULK STORAGE HANGAR (EXISTING)
10	U.S. NAVY BUILDING (EXISTING)
11	JET FUEL STORAGE (TENANT - EXISTING)
12	T-HANGAR / EXECUTIVE HANGAR (FUTURE)
13	CONVENTIONAL HANGAR (FUTURE)
14	AVIATION FUEL STORAGE (FUTURE)
15	AVIATION FUEL TRUCK PARKING (FUTURE)
16	TERMINAL/FBO APRON
17	SMALL AIRCRAFT TIEDOWN APRON (EXISTING)
18	LOCALIZER ANTENNA ARRAY (EXISTING)
19	GLIDE SLOPE ANTENNA (EXISTING)
20	NONDIRECTIONAL BEACON (EXISTING)
21	MALS - R APPROACH LIGHTING SYSTEM (EXISTING)
22	MALS - R APPROACH LIGHTING SYSTEM (FUTURE)
23	AWOS-3 (EXISTING)
24	AIRPORT DINER RESTAURANT
25	AIRPORT INDUSTRIAL PARK
26	DRAG RACING FACILITY (TO BE RELOCATED)
27	ADS-B ANTENNA
28	VEHICLE PARKING (EXISTING)

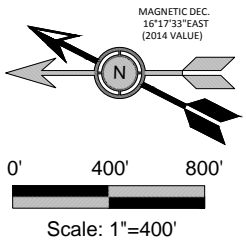

"RUNWAY EXTENSION RESERVES SHOWN TO DEPICT FUTURE CONCEPTUAL LAYOUT AND PROTECTION ZONES ONLY. ADDITIONAL FAA AND LOCAL COORDINATION, AND JUSTIFICATION WILL BE REQUIRED AS PART OF ANY FUTURE PLANNING."

"THE PREPARATION OF THIS DOCUMENT MAY HAVE BEEN SUPPORTED, IN PART, THROUGH THE AIRPORT IMPROVEMENT PROGRAM FINANCIAL ASSISTANCE FROM THE FEDERAL AVIATION ADMINISTRATION (PROJECT NUMBER 3-53-0007-26-2012) AS PROVIDED UNDER TITLE 49, UNITED STATES CODE, SECTION 47104. THE CONTENTS DO NOT NECESSARILY REFLECT THE OFFICIAL VIEWS OR POLICY OF THE FAA. ACCEPTANCE OF THIS REPORT BY THE FAA DOES NOT IN ANY WAY CONSTITUTE A COMMITMENT ON THE PART OF THE UNITED STATES TO PARTICIPATE IN ANY DEVELOPMENT DEPICTED THEREIN NOR DOES IT INDICATE THAT THE PROPOSED DEVELOPMENT IS ENVIRONMENTALLY ACCEPTABLE IN ACCORDANCE WITH APPROPRIATE PUBLIC LAWS."

**NON-STANDARD CONDITIONS**

NO.	ITEM	DESCRIPTION	DISPOSITION
1	TAXILANE OFA	LESS THAN STANDARD CLEARANCE FROM CENTERLINE TO PARKED AC	RECONFIGURATION (TAXILANE / APRON)
2	TAXILANE OFA	LESS THAN STANDARD CLEARANCE FROM HANGAR TAXILANES	NONE

NO.	DATE	BY	APPR	REVISIONS

**VERIFY SCALES**  
 BAR IS ONE INCH ON ORIGINAL DRAWING. 0" = 1" IF NOT ONE INCH ON THIS SHEET, ADJUST SCALES ACCORDINGLY.

**FEDERAL AVIATION ADMINISTRATION APPROVAL**  
 APPROVAL DATE: \_\_\_\_\_  
 \_\_\_\_\_  
 SIGNATURE

**PORT OF BREMERTON APPROVAL**  
 APPROVAL DATE: \_\_\_\_\_  
 \_\_\_\_\_  
 SIGNATURE

**CENTURY WEST ENGINEERING CORPORATION**

BEND OFFICE  
 1020 SW EMKAY DRIVE #100  
 BEND, OR 97702  
 541.322.8962  
 541.382.2423 (FAX)  
 WWW.CENTURYWEST.COM

DESIGNED BY: DM    DRAWN BY: JLS    CHECKED BY: WMR    SCALE: AS SHOWN  
 DATE: MAY 2015    PROJECT NO: 1244500101